

Ashley Court, Morningside – Development Update.



Ashley Court, Morningside

Ashley Court Nursing Home in Morningside is a beautiful residence that opened in 1995. By offering en-suite facilities for all rooms (some with showers), it led the way for nursing homes in the UK.

More than 20 years on, Ashley Court is still leading the way. Many other homes around the UK still don't offer the same level of facilities, though all of the other homes in the Randolph Hill Nursing Home Group which were built after Ashley Court do.

We're not ones to rest on our laurels though, so in 2012 we embarked on a programme to refurbish Ashley Court and ensure it reached the standards we'd expect of a new build home.

So far, we have already created a number of new premium and deluxe rooms, meaning residents can choose larger suites with enhanced facilities. These enhancements include the likes of Porcelanosa ceramic en suite tiling, Farrow & Ball paint, premium electrical brands and en-suite furnishings.

Our work on enhancing the central area has also been completed, meaning the opening of a stunning new lounge area, a hairdressing salon and a resident-accessible kitchen that can aid in regaining greater personal independence.



Ashley Court

a Randolph Hill Nursing Home

Our rooms at Ashley Court.#

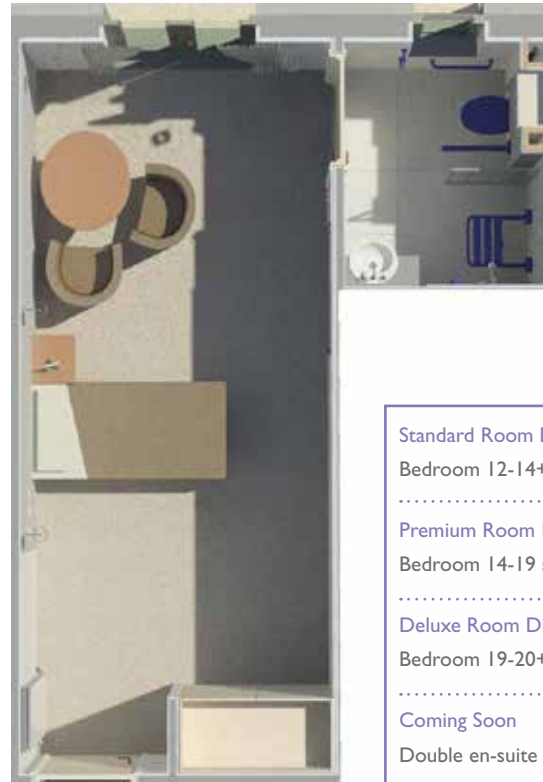

Standard Room Dimensions
Bedroom 12-14+ sq.m
.....
Premium Room Dimensions
Bedroom 14-19 sq.m
.....
Deluxe Room Dimensions
Bedroom 19-20+ sq.m
.....
Coming Soon
Double en-suite rooms

Example of Premium Room Layout from Muirfield Nursing Home.

Our bathroom facilities are also being improved to include a range of features that will allow us to support and assist residents in new ways.

For example, the completed work will mean all Ashley Court rooms having full wet floor en suite shower rooms with premium finishes. There will also be a range of room sizes, including two-room suites.

These refurbishments are a sign of our commitment to supporting residents. We also offer a range of activity programmes, including bus trips, cinema days, exercise and games. For those who prefer to take things a little easier,

our main lounge has a cinema screen. This is perfect for enjoying movie nights and major sporting or other events. The lounges also have full Sky TV packages, including movies and sports and residents can enjoy the availability of a range of Sky channels in their bedrooms.

All of this comes along with the care you can expect from Randolph Hill, as discussed in our main brochure. Call now to enquire about our standard, premium and de-luxe rooms

Imagery shown is representative of furnished rooms, but are subject to change.

If you'd like more information about Ashley Court, or to arrange a tour of our nursing home, please call Carol Morrison, Manager: 0131 447 2345 or go to www.randolphhill.com